



A DIVISION OF GETZ FIRE EQUIPMENT

**GETZ EQUIPMENT INNOVATORS
PART NO. 4G59456
HIGH LOW WALL MOUNT PUMP
W/o AIR DRYER (REVISED 4/29/10)**



2320 Lakecrest Drive, Pekin IL 61554

PH. (888) 747-4389 • Fax (309) 495-0625

Website: www.getzequipment.com

LIMITED WARRANTY

Products manufactured by Getz Equipment Innovators (with exception of electrical products or components) will be free from defects for a period of one year from shipment date. Electrical products and/or components used in manufactured products will have a (6) month warranty from shipment date. During the warranty period, customers who experience any manufacture-related service issues with our products, the product may be returned for repair or replacement. Customer must contact Getz Equipment for approval prior to any product return. Notwithstanding the foregoing, the limited warranty set forth shall be immediately void of customer uses any replacement parts other than those provided by Getz Equipment Innovators. The warranty does not cover normal wear and tear items, defects resulting from modification, alteration, misuse, exposure to corrosive conditions, extremely high temperatures, improper installation or maintenance. Warranties on component items not manufactured by Getz Equipment Innovators are provided by others whose warranty, evaluation and judgment will be final. All implied warranties, including, but not limited to, warranties of fitness for purpose and merchantability, are limited to the time periods as stated above. In no event shall Getz Equipment Innovators be liable to incidental or consequential damages. Some states do not allow limitations on how long an implied warranty lasts or the exclusions or limitation of incidental or consequential damages, so that the above limitations or exclusions may not apply to you. Getz Equipment Innovators neither assumes nor authorizes any representative or other person to assume for it any obligation or liability other than as expressly set forth herein.

Mobile Service Vehicles:

The warranty does not cover:

- Defects in the chassis and or power unit
- Defects in separately manufactured products not produced by Getz Equipment Innovators
- Deterioration due to normal wear, tear, and exposure
- Repairs made necessary by negligent use, misuse, abuse, loading the service vehicle beyond its gross vehicle weight limitations, accident, acts of God, or other contingencies beyond the control of Getz Equipment Innovators.
- Repairs deemed necessary by reason of the failure to follow ordinary maintenance procedures.
- Repairs deemed necessary by reason of alterations done without Getz Equipment Innovators' written approval.

Warranty Service:

- All warranty repairs will be performed by Getz Equipment Innovators in Pekin, IL, unless otherwise authorized by Getz Equipment Innovators.
Freight:
- Getz Equipment Innovators will not be liable for shipping or transportation charges to or from customer's location.

This warranty gives you specific legal rights, and you may also have other rights which vary from state to state. To obtain performance to the obligation of the warranty, write to Getz Equipment Innovators, 2320 Lakecrest Drive, Pekin IL 61554, USA for instructions.

TABLE OF CONTENTS

1	INSTALLATION
2	PUMP OPERATION
3	MAINTENANCE AND SYSTEM REQUIREMENTS
4	VALVE DIAGRAM
5	PUMP w/o DRYER
6	PUMP w/ DRYER
7	WALL MOUNTING

WALL BRACKET INSTALLATION

THIS EQUIPMENT MUST BE MOUNTED TO A SOLID SURFACE.
PUMP VIBRATION CAN CAUSE HARDWARE TO BECOME LOOSE AND PUMP TO FALL.

MOUNTING LOCATION

Mount in a location accessible to air supply, ground for grounding clamp and close to your supply tank.

Concrete Wall Installation

1. Using the template provided, mark holes for drilling.
2. Use a 1/2" concrete drill bit to drill the four bracket mounting holes.
3. Insert the lead lugs in the drilled holes. Lugs should be approx. 1/8" below wall surface.
4. Set with tool provided.
5. Mount the bracket to the wall using the hardware and rubber spacers provided.

Other Solid Wall Surfaces

1. Using the template provided, mark holes for drilling
2. Use a 5/16 drill bit to drill four bracket mounting holes.
3. Mount the bracket using the rubber spacers. (additional hardware not included)

MOUNTING THE PUMP

1. When your wall bracket is securely mounted you can attach the pump.
2. Place the pump on the wall bracket
3. Bolt the pump to the bracket using the supplied hardware

ATTACHING HOSES

C02 Inlet

Attach #5 hose to the liquid port of your C02 supply tank. Supply should exceed maximum flow being delivered by the pump. **DO NOT RUN THE PUMP DRY.** Pipe size must be a minimum of one size larger than the pump inlet fitting. Avoid tees, elbows, or valves in the inlet pipe to reduce the risk of flow restriction and cavitation. The simpler the inlet plumbing; the less the potential for problems. Use pipe sealant to assure air-tight, positive sealing pipe joints.

NOTE: Insulate the liquid supply pipe with cold temperature pipe-wrap to avoid gasification in the inlet line.

Air Inlet

The air inlet line must be connected to an air supply line with an inline dryer rated to minimum -40 dew point, 25 CFM, at 100 PSI

NOTE: If the pump cannot be located near the filling site due to CO2 supply pipe limitations, the air inlet valve may be located up to 20 feet away from the pump. This allows the pump to be remotely operated. If the pump is remotely operated, hard pipe the fill line from the pump to the filling site.

Ground Clamp

Attach the ground clamp to any grounded metal in the area. This will eliminate static shock which can affect pump life.

FILLING AN EXTINGUISHER

PLACE THE FILL VALVE #6 IN THE OFF POSITION BEFORE OPENING SUPPLY TANK AS SEEN ON PAGE 4

1. Check the hydrostatic test date on the extinguisher to be filled and comply with all retest laws and procedures before beginning. Note the fill weight and attach the fill adapter.
2. With valve #6 in the off position, open the liquid valve from your C02 supply tank.
3. Grip valve #6 firmly and slowly turn the valve to the on position.
4. Allow C02 to free flow until a stream of white snow is seen and turn the valve to the closed position.
5. Attach the hand-wheel to the refill adapter.
6. Open the extinguisher valve using a spring clamp and tare the scale.
7. Turn #6 valve to the fill position and open valve #16 to the on position.
8. When the desired weight is reached turn valve #16 to the off position.
9. Remove the spring clamp from the extinguisher valve.
10. Turn valve #6 to the vent position to relief adapter pressure and remove the #7 hand wheel.
11. Remove the adapter, attach hoses or other hardware and verify weight.

MAINTENANCE

DAILY

Inspect hoses for damage before using, and replace if needed.
Inspect bracket mount.

SYSTEM REQUIREMENTS

Compressed Air Minimum 25 CFM
Minimum 100 PSI at - 40 Dew point
High or low pressure supply cylinder minimum 250 PSI

HARDWARE

4 – ¼ -20 x ¾ hex bolts
4 – ¼ -20 nuts
8 – ¼ lock washers
12 – ¼ flat washers
4 – ¼ -20 x 1 ¾ bolts

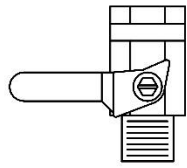

CLOSED

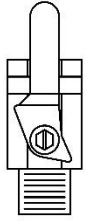

OPEN

FILL

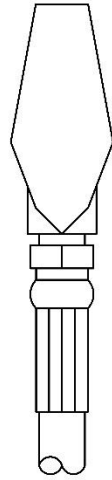

VENT

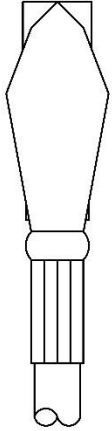

OFF

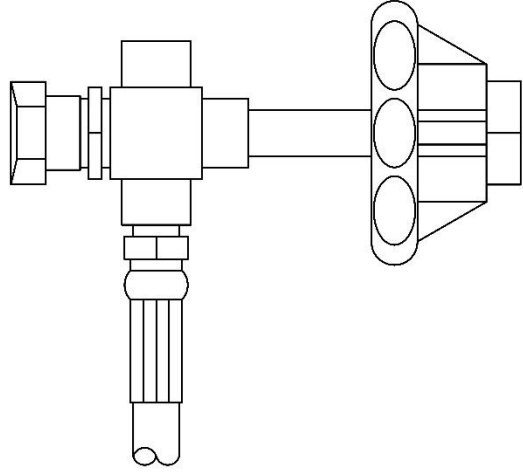
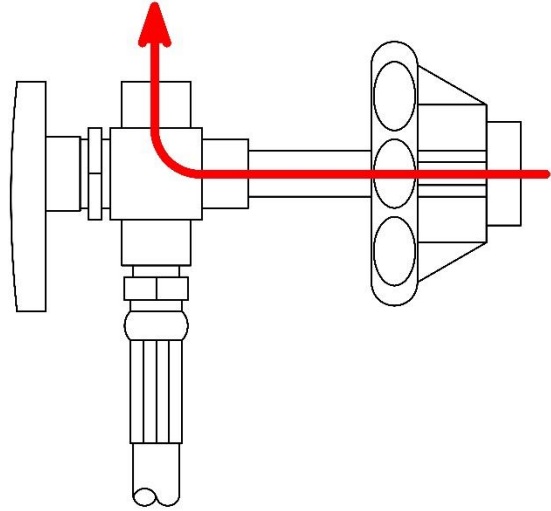
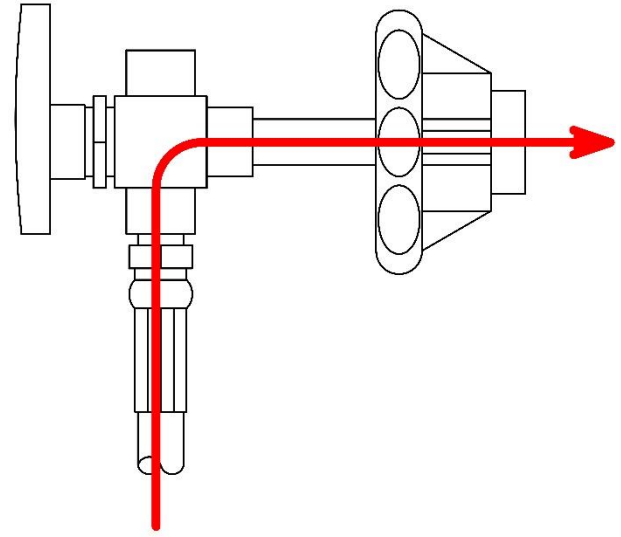
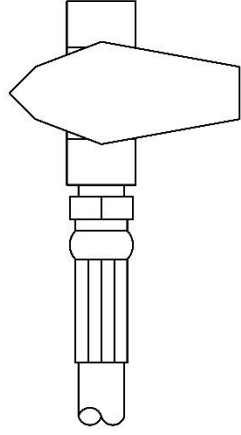

ITEM	PART#	DESCRIPTION
1	1G0049	1/4 3 WAY BALL VALVE
2	1G0116	1/4 TUBE X 1/4 MPT PLASTIC ELBOW
3	1G53770	HIGH/LOW CO2 PUMP W/MUFFLERS
4	1G53719	3/4 X 1/2 SS PIPE BUSHING
5	1G56244	6 FOOT LOW PRESSURE FEED HOSE
6	1G0061	3 WAY CO2 FILLING VALVE
7	3G59068	STEM, NUT & GRIPWHEEL
8	1G53627	GENERANT RELIEF VALVE
9	3G56230	6 FOOT CO2 FILL LINE W/CPLGS
10	1G53654	1/4 BRASS PIPE TEE ST 3000PSI
11	1G51684	1/2 X 1/4 BR PIPE REDUCER
12	1G51683	3/8 X 1/4 BR PIPE REDUCER
13	1G0428	1/4 BRASS TEE
14	N/A	NOT IN USE
15	1G0051	100 PSI PRESSURE RELIEF VALVE
16	1G0042	1/4 TURN, 1/4 ML X 1/4 FMLE VLV
17	1G0116	3/8 TUBE X 1/4 MPT PLASTIC CON
18	1G53764	WALL MOUNT BRACKET
19	3G59457	GROUNDING CLAMP
20	1G0172	1/2" CO2 ADAPTER
21	1G0170	1/4" CO2 ADAPTER
22	1G0173	1/8" CO2 ADAPTER
23	1G0171	3/8" CO2 ADAPTER
24	1G51367	4000 PSI GAUGE 2 MECO DRY
25	1G53654	1/4 BR PIPE TEE ST 3000PSI
26	3G59458	RUBBER SHOCK ABSORBER
27	1G53767	TOOL ANCHOR SET
28	1G53766	ANCHOR BRACKET MOUNT

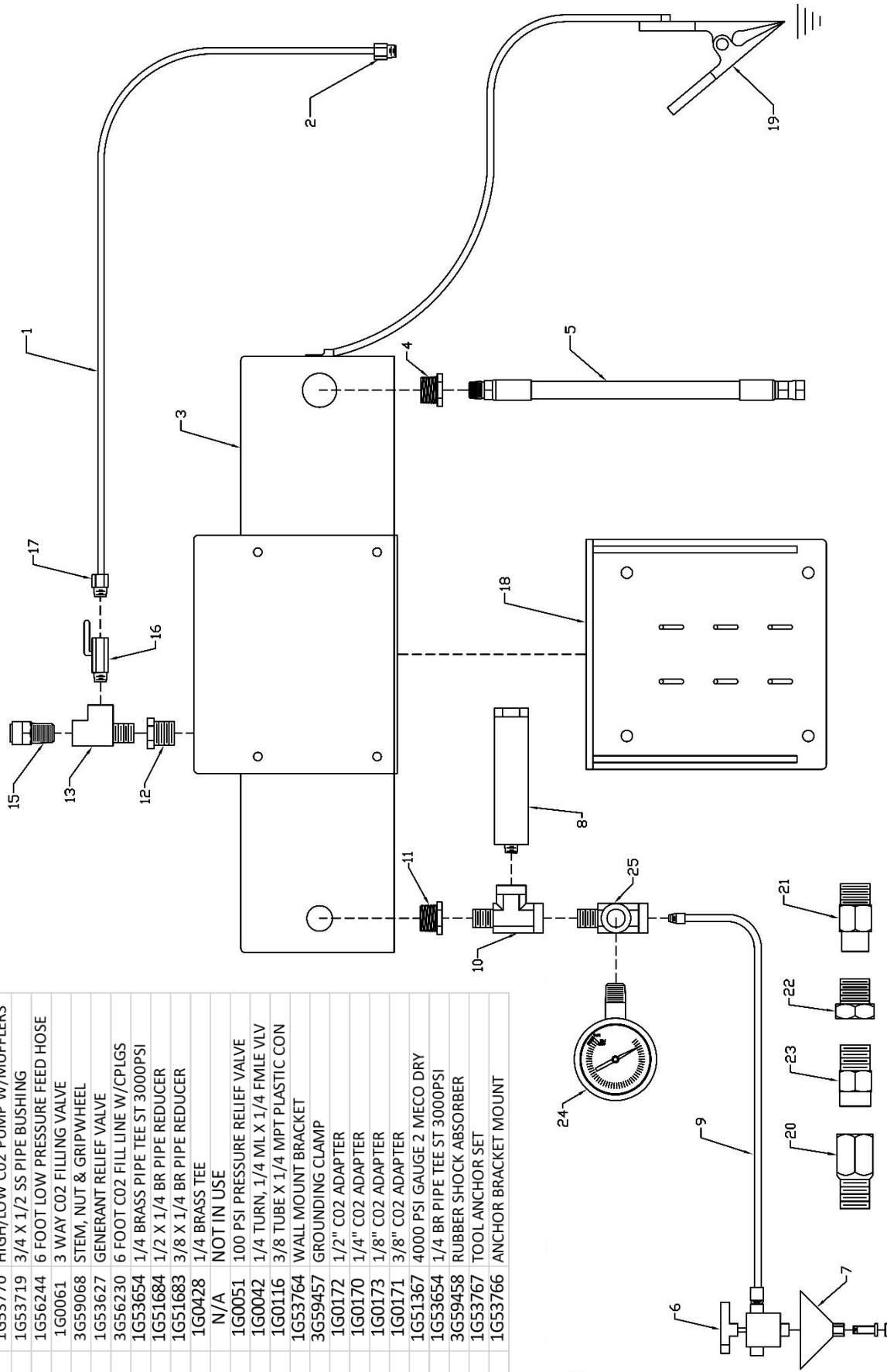

ITEM	PART#	DESCRIPTION
1	1G0049	3/8 WHITE POLY TUBING PER FOOT
2	1G0116	1/4 TUBE X 1/4 MPT PLASTIC ELBOW
3	1G53770	HIGH/LOW CO2 PUMP W/MUFFLERS
4	1G53719	3/4 X 1/2 SS PIPE BUSHING
5	3G56244	6 FOOT LOW PRESSURE FEED HOSE
6	1G0061	3 WAY CO2 FILLING VALVE
7	3G59068	STEM, NUT & GRIPWHEEL
8	1G53627	GENERANT RELIEF VALVE
9	3G56230	6 FOOT CO2 FILL LINE W/CPLGS
10	1G53654	1/4 BRASS PIPE TEE ST 3000PSI
11	1G51684	1/2 X 1/4 BR PIPE REDUCER
12	1G51683	3/8 X 1/4 BR PIPE REDUCER
13	1G0428	1/4 BRASS TEE
14	N/A	NOT IN USE
15	1G0051	100 PSI PRESSURE RELIEF VALVE
16	1G0042	1/4 TURN, 1/4 ML X 1/4 FMLE VLV
17	1G0116	3/8 TUBE X 1/4 MALE PLASTIC CON
18	1G53764	WALL MOUNT BRACKET
19	1G59543	AIR DRYER COMPLETE
20	3G59457	GROUNDING CLAMP

21	1G0172	1/2" CO2 ADAPTER
22	1G0170	1/4" CO2 ADAPTER
23	1G0173	1/8" CO2 ADAPTER
24	1G0171	3/8" CO2 ADAPTER
25	1G51367	4000 PSI GAUGE 2 MECO DRY
26	1G53654	1/4 BR PIPE TEE ST 3000PSI
27	1G53946	3/9 MALE PIPE X 1/2 FEMALE ADAPTER

