



A DIVISION OF GETZ FIRE EQUIPMENT

**GETZ EQUIPMENT INNOVATORS
PART NO: 3G59602
SYS FILL 50LB STAINLESS STEEL
CONVENTIONAL VACUFILL SYSTEM**



2320 Lakecrest Drive, Pekin, Illinois 61554
Telephone: 888-747-4389 Fax: 309-495-0625
Website: www.getzequipment.com

EQUIPMENT INNOVATORS

Limited Warranty

Products manufactured by Getz Equipment Innovators (with exception of electrical products or components) will be free from defects for a period of one year from shipment date. Electrical products and/or components used in manufactured products will have a (6) month warranty from shipment date. During the warranty period, customers who experience any manufacture-related service issues with our products, the product may be returned for repair or replacement. Customer must contact Getz Equipment for approval prior to any product return. Notwithstanding the foregoing, the limited warranty set forth shall be immediately void of customer uses any replacement parts other than those provided by Getz Equipment Innovators. The warranty does not cover normal wear and tear items, defects resulting from modification, alteration, misuse, exposure to corrosive conditions, extremely high temperatures, improper installation or maintenance. Warranties on component items not manufactured by Getz Equipment Innovators are provided by others whose warranty, evaluation and judgment will be final.

All implied warranties, including, but not limited to, warranties of fitness for purpose and merchantability, are limited to the time periods as stated above. In no event shall Getz Equipment Innovators be liable to incidental or consequential damages. Some states do not allow limitations on how long an implied warranty lasts or the exclusions or limitation of incidental or consequential damages, so that the above limitations or exclusions may not apply to you. Getz Equipment Innovators neither assumes nor authorizes any representative or other person to assume for it any obligation or liability other than as expressly set forth herein.

Mobile Service Vehicles:

The warranty does not cover:

- Defects in the chassis and or power unit
- Defects in separately manufactured products not produced by Getz Equipment Innovators
- Deterioration due to normal wear, tear, and exposure
- Repairs made necessary by negligent use, misuse, abuse, loading the service vehicle beyond its gross vehicle weight limitations, accident, acts of God, or other contingencies beyond the control of Getz Equipment Innovators.
- Repairs deemed necessary by reason of the failure to follow ordinary maintenance procedures.
- Repairs deemed necessary by reason of alterations done without Getz Equipment Innovators' written approval.

Warranty Service:

- All warranty repairs will be performed by Getz Equipment Innovators in Pekin, IL, unless otherwise authorized by Getz Equipment Innovators.

Freight:

- Getz Equipment Innovators will not be liable for shipping or transportation charges to or from customer's location.

This warranty gives you specific legal rights, and you may also have other rights which vary from state to state. To obtain performance to the obligation of the warranty, write to Getz Equipment Innovators, 2320 Lakecrest Drive, Pekin IL 61554, USA for instructions.

GETZ SYS FILL 50LB SS VACU-FILL SYSTEM

TABLE OF CONTENTS

PAGE #	
1 GETZ SYS FILL 50LB SS VACU-FILL SYSTEM
2 PARTS LIST
3 PARTS LIST CONT.
4 DRAWING #1 - GENERAL ASSEMBLY
5 DRAWING #2 - CONSOLE AND FILTER ASSEMBLY
6 DRAWING #3 - CONSOLE LID INTERIOR
7 DRAWING #4 - CONSOLE BODY INTERIOR
8 DRAWING #5 - ARRANGEMENT OF COMPONENTS
9 SET-UP INSTRUCTIONS
10 PROCEDURE FOR DISCHARGING FIRE EXT.
11 PROCEDURE FOR FILLING FIRE EXT.
12 TROUBLE SHOOTING & SERVICE AIDS
13 TROUBLE SHOOTING & SERVICE AIDS - CONT.
14 RECOMMENDED MAINTENANCE KIT

GETZ SYS FILL 50LB SS VACU-FILL SYSTEM

MOTIVE POWER SOURCE

AIR COMPRESSOR
COMPRESSED AIR
NITROGEN
CO2 VAPOR

NOTE: CUSTOMER MUST REMOVE THE SIPHON TUBE FROM THE SUPPLY VALVE OF THE LIQUID CO2 TANK TO HAVE VAPOR.

TO GET THE MAXIMUM PERFORMANCE FROM YOUR VACU-FILL, THE OPERATING INPUT PRESSURE MAY RANGE FROM 50 TO 80 PSI. TO SET YOUR REGULATOR FOR BEST RESULTS, TAKE THE WHITE VACUUM LINE (#5) OUT OF CONNECTOR (#35) ON THE BOTTOM LEFT OUTSIDE CONSOLE. TURN THE ON-OFF VALVE (#19) TO THE "ON" POSITION AND PUT YOUR FINGER OVER CONNECTOR (#35). THEN, ADJUST REGULATOR UP OR DOWN, WHICHEVER IS NEEDED, SO THAT YOU HAVE THE MAXIMUM ON YOUR GAUGE.

CYCLE TIMES TO EXHAUST (OR EMPTY)

5 LB EXTINGUISHER (2.27 KG) = 15 SECONDS
10 LB EXTINGUISHER (4.50 KG) = 25 SECONDS
20 LB EXTINGUISHER (9.00 KG) = 30 SECONDS

CYCLE TIMES TO FILL

5 LB EXTINGUISHER (2.27 KG) = 10 SECONDS
10 LB EXTINGUISHER (4.50 KG) = 15 SECONDS
20 LB EXTINGUISHER (9.00 KG) = 30 SECONDS

SHIPPING SIZE OF CONTAINER

SGL SV 50 PR – 18" X 18" X 28"

OPTIONAL EQUIPMENT

59640- RING CAPACITY EXPANSION SS COMP - EXPANDS YOUR HOPPER'S CAPACITY BY 50LB EACH.

WARNING: MUST WEAR SAFETY GLASSES

PARTS LIST

DRAWING #	PART #	DESCRIPTION
1	1G54165	LID HOPPER ROUND SS
2	1G54163	HOPPER w/ STAND SS 50LB
3	3G58545	DCH ASY
4	1G0049	MTL NYCOIL 3/8" WH
5	1G0048	MTL NYCOIL 1/4 WH
6	1G0032	MTL VINYL TUBE 1/2 CLR X 9'
7	1G51221	CONE FILL
8	3G59608	CONSOLE SV1 SS COMP CONVENT
9	1G51484	LID SV1 CONSOLE
10	1G51148	BOX CONSOLE SV1
11	1G0207	STEM FILTER AC-396
12	1G0067	FLTR WH JAR ASSY
13	1G0206	CAP FLTR
14	1G51436	JAR PLASTIC VACU-FILL
15	1G51709	PIPE UNION PLAS 3/8 BLKHD
16	1G0101	CLAMP PLAS HOPPER OUTLET
17	1G0116	CONN PLAS 1/4
18	1G51285	DECAL LEXAN PANEL SV1
19	3G58649	VALVE ON-OFF BR SV1
20	1G0120	PIPE ELB PLAS 1/4ML X 1/4TUBE
21	1G51590	NUT & FERRULE 1/4 PLAS
22	1G54206	PIPE ELB PLAS 1/4 FMLE X 1/2 BARB
23	1G52636	PIPE ELB PLAS 1/8 ML X 1/4 TUBE
24	1G51695	PIPE TEE BR 1/4 BOX
25	1G54188	FLTR LID BAG-STYLE
26	1G0099	PIPE ELB PLAS w/BARB
27	1G51680	PIPE RDCR BELL 1/4 X 1/8
28	1G51302	FASTENER LOCKING CONSOLE
29	1G0018	GAUGE 30MG VACUUM
30	1G54400	VENTURI NEW STANDARD
31	1G0048	MTL NYCOIL 1/4 WH
32	1G54205	CLAMP FLTR 2.5IN
33	1G51710	PIPE UNION RDCR PLAS 3/8 X 1/4
34	1G0049	MTL NYCOIL 3/8 WH
35	1G51233	CONNECTOR PLAS 1/4FML X 1/4TUB
36	1G0011	BKT FLTR ASY JAR CLP
37	1G0017	FLTR ASY CASTING W/O JAR
38	1G51592	NUT & FERRULE 3/8 PLAS
39	1G51653	PIPE NIP BR 1/4 X 3 1/2
40	1G0205	GASKET JAR
41	1G51789	SCREEN DCH
42	1G0083	PIPE PLUG 1/4 BR
43	1G51686	PIPE RDCR BR 3/4X1/2
44	1G0077	PIPE ELB BR 1/2 MALE
45	1G0084	VLV BALL BR 1/2
46	1G0075	BARB HOSE BR 1/2 X 1/2
47	1G0033	MTL NYLON TUBE DCA1 5/8 - 24"
48	1G0076	BARB HOSE BR 1/2 X 1/4
49	1G0028	CPLG 1/4 FMLE STR THRU
50	1G0025	CPLG 1/4 X 1/8 ML STR

PARTS LIST CONTINUED

DRAWING #	PART #	DESCRIPTION
51	3G58561	FTNG BR FILLER TUBE COMP
52	XXXXX	LATCH HOPPER
53	1G0159	CLAMP BROOM
54	1G54621	BRKT RING SS
55	1G54176	VLV DETENT/MOMENTARY
56	1G52083	PIPE ELB 1/8 STR BR
57	1G51670	PIPE PLUG BR 1/8 SQ HEAD
58	1G54198	PIPE FTNG 1/8MPT x 1/4TUBE PTC
59	1G54166	GASKET LID ROUND
60	1G0048	MTL NYCOIL 1/4 WH
61	1G54196	PIPE FTNG 1/4 MPT x 1/4 TUBE PTC
62	1G52601	PIPE UNION BRASS 1/4 BLKD
63	1G51702	PIPE TEE PLAS 1/4 TUBE
64	1G0136	CONN PLAS 1/4 ML x 1/4 TUBE
65	3G56238	HOSE VENT 6' #3

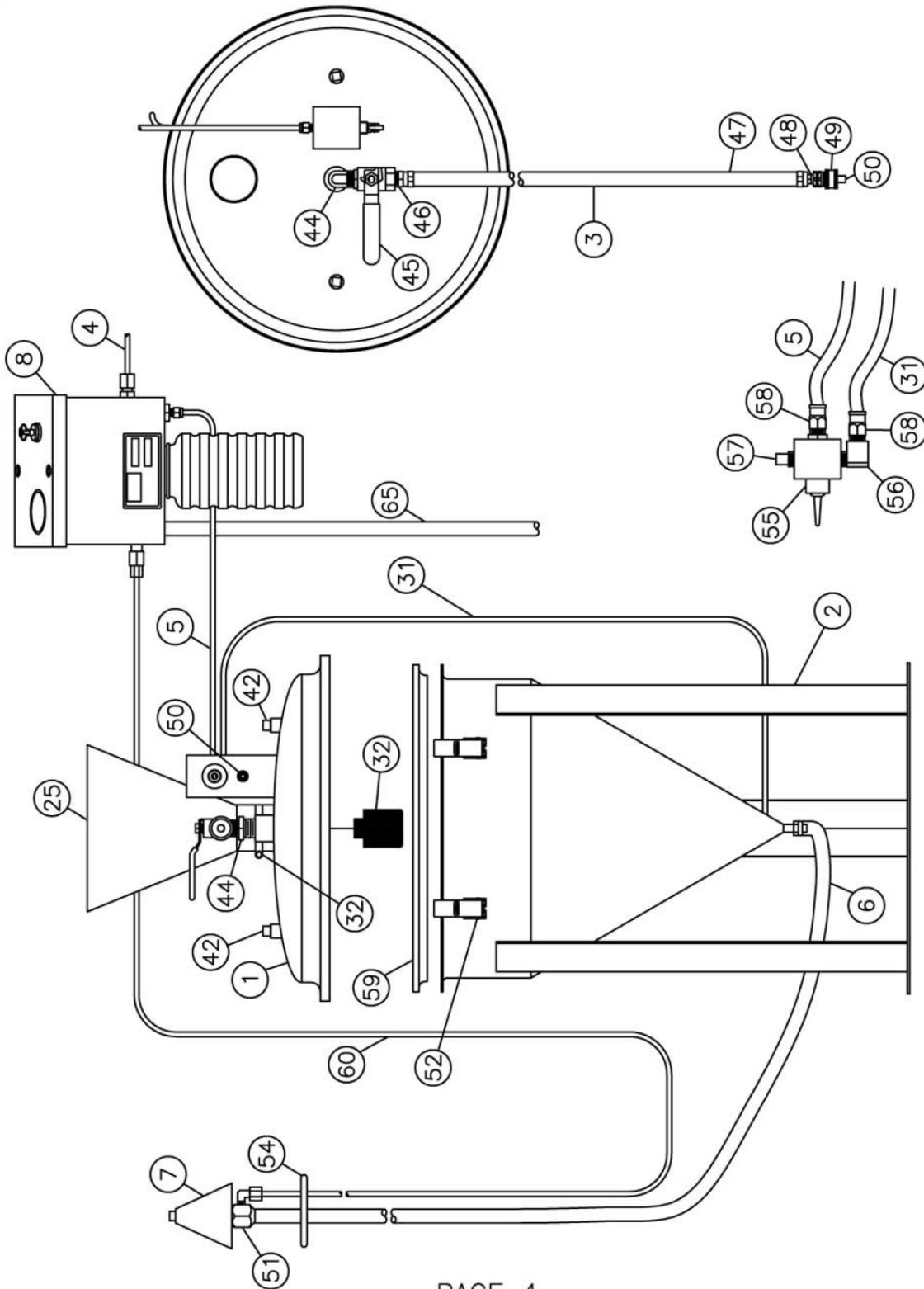

THIS DRAWING IS THE EXCLUSIVE AND CONFIDENTIAL PROPERTY OF GETZ EQUIPMENT. IT SHALL NOT BE
 DUPLICATED, USED OR DISCLOSED TO OTHERS WITHOUT THE EXPRESS WRITTEN CONSENT OF GETZ EQ.

DRAWING CHANGE		BY	ECN NO.	DATE	MATERIAL	FINISH	GETZ EQUIPMENT INNOVATORS PEKIN, IL 61554	SHEET NO. 1 OF 5	BIN NO.
TOLERANCES UNLESS OTHERWISE SPECIFIED					DWN BY C.F.G.	CK'D K.L.R.		DWG. NO. 3G59602	REV. *
FRAC. ±.020	2 PL DEC ±.010	3 PL DEC ±.003			SCALE 1/8" = 1"	DATE 4-9-09	TITLE STAINLESS STEEL VACUFILL SYS		

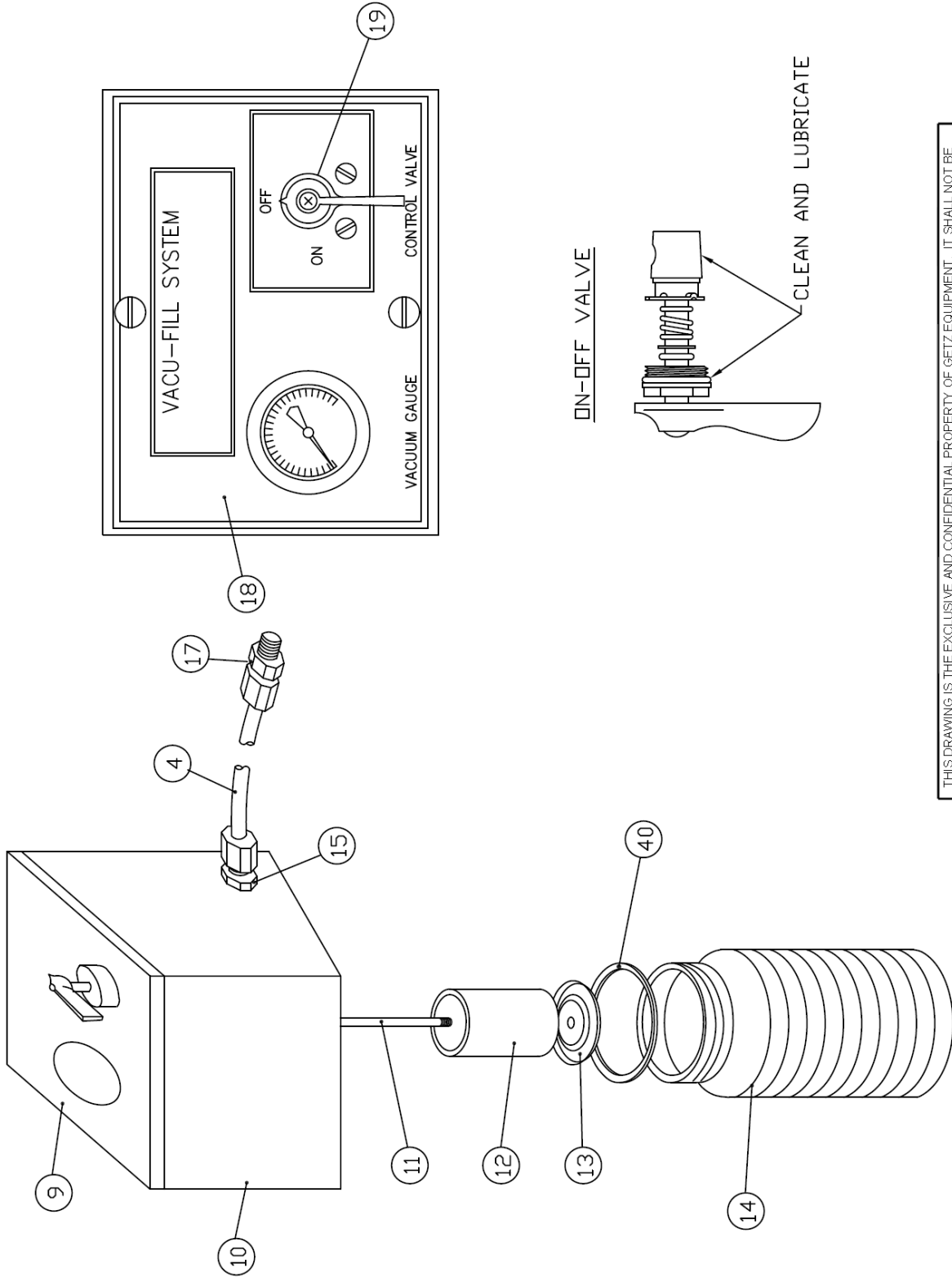

THIS DRAWING IS THE EXCLUSIVE AND CONFIDENTIAL PROPERTY OF GETZ EQUIPMENT. IT SHALL NOT BE DUPLICATED, USED OR DISCLOSED TO OTHERS WITHOUT THE EXPRESS WRITTEN CONSENT OF GETZ EQ.		SHEET NO. 2 OF 5		BIN NO.	
MATERIAL		FINISH		GETZ EQUIPMENT INNOVATORS	
DWN BY CPG		K&P K.L.R.		PEKIN, IL 61554	
SCALE NTS		DATE 2-2-10		TITLE SS CONTROL CONSOLE	
REV	DRAWING CHANGE	BY	ECN NO.	DATE	REV.
					*
TOLERANCES UNLESS OTHERWISE SPECIFIED		3 PL DEC ± .003		DWG. NO. 3G59602-2	
FRAC. ±.020		2 PL DEC ±.010			

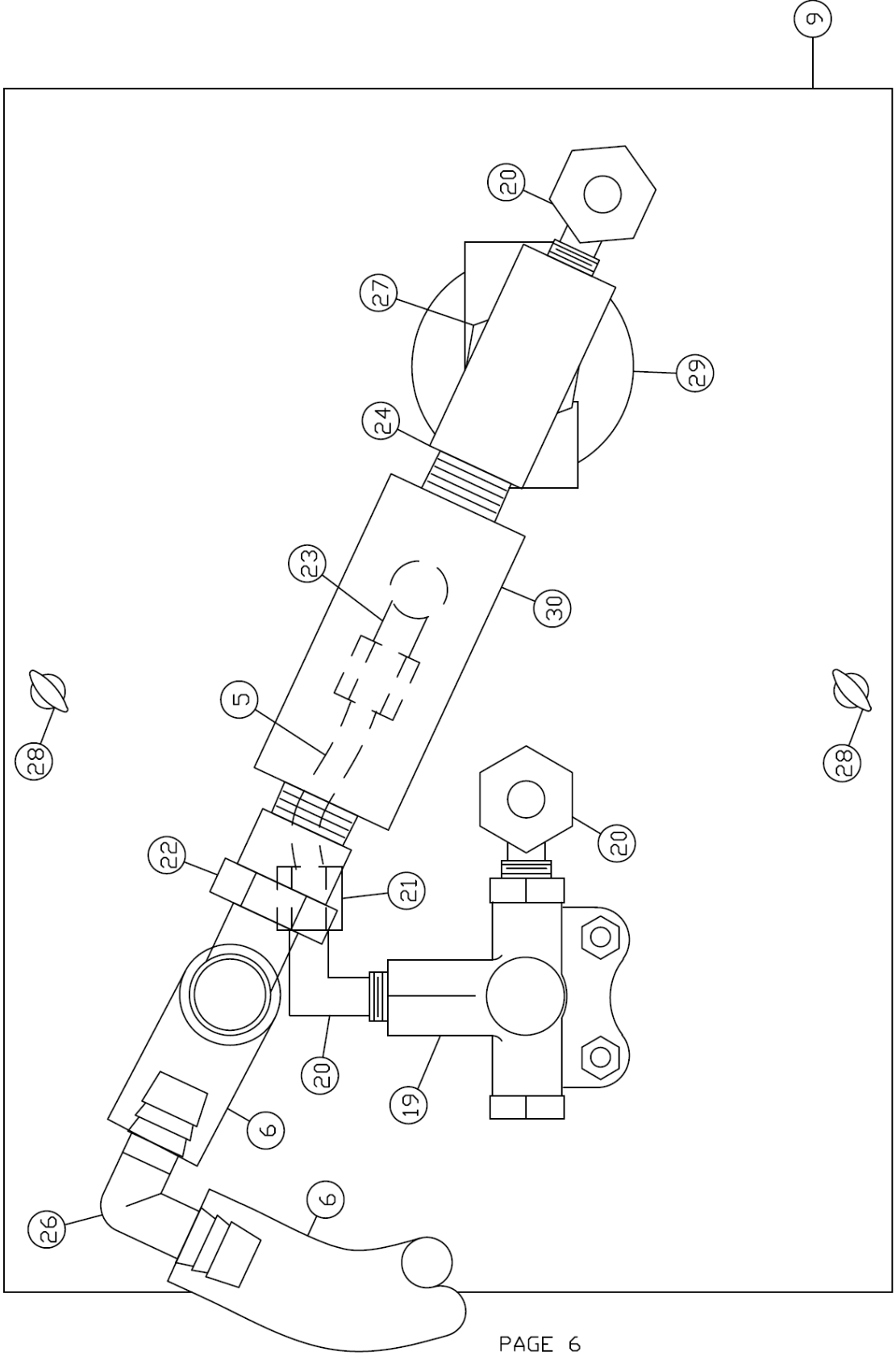

THIS DRAWING IS THE EXCLUSIVE AND CONFIDENTIAL PROPERTY OF GETZ EQUIPMENT. IT SHALL NOT BE DUPLICATED, USED OR DISCLOSED TO OTHERS WITHOUT THE EXPRESS WRITTEN CONSENT OF GETZ EQ.

MATERIAL		FINISH		SHEET NO.		BIN NO.	
DWN BY CPG		CK'D K.L.R.		3 DF 5			
DATE		DATE		DWG. NO.		REV.	
12-11-09		12-11-09		3G59602-3		*	
TOLERANCES UNLESS OTHERWISE SPECIFIED				TITLE SS CONTROL CONSOLE			
FRAC. ±.020	2 PL DEC ±.010	3 PL DEC ±.003					
<p>GETZ EQUIPMENT INNOVATORS PEKIN, IL 61554</p>							

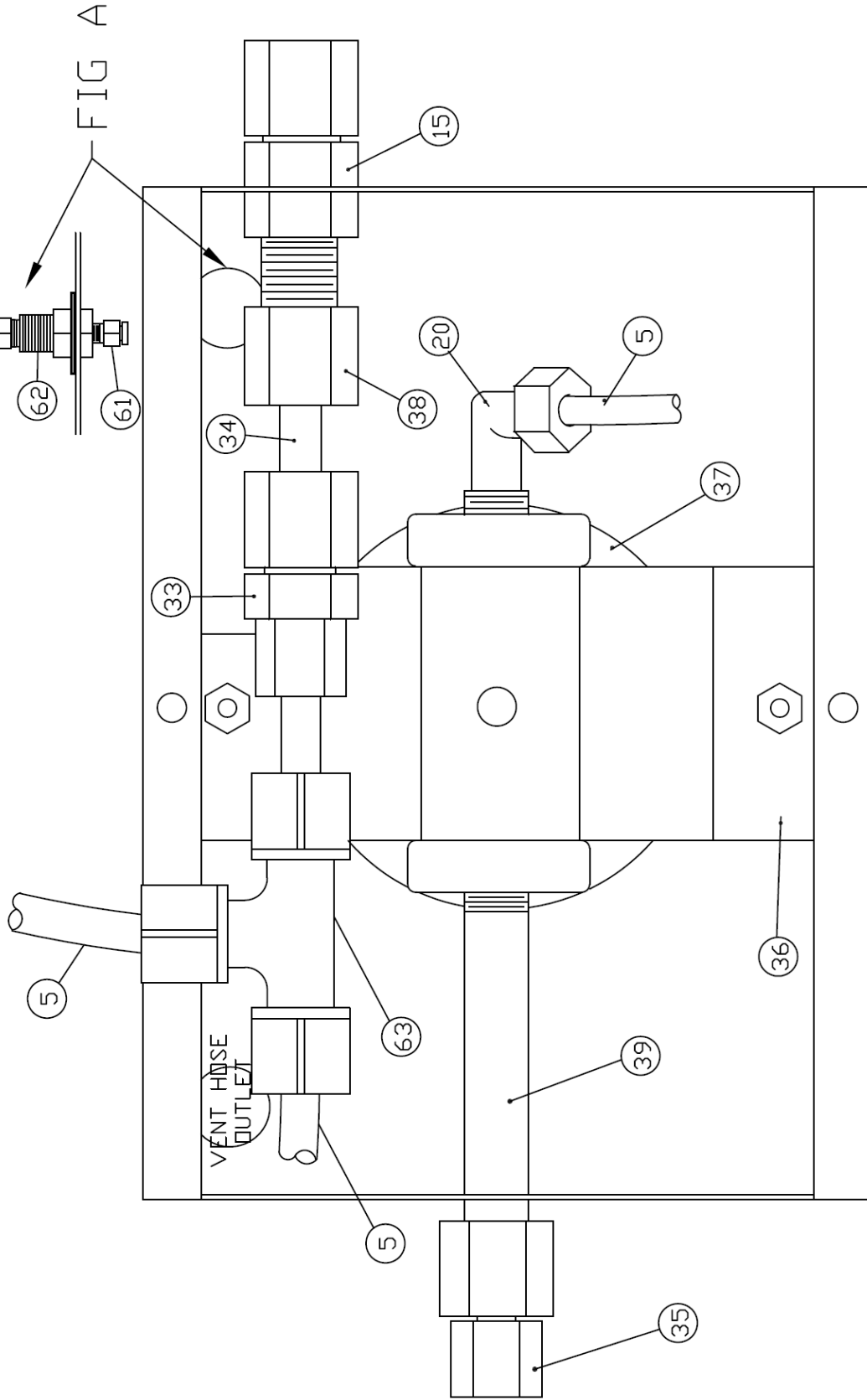

FRONT OF CONSOLE BODY

THIS DRAWING IS THE EXCLUSIVE AND CONFIDENTIAL PROPERTY OF GETZ EQUIPMENT. IT SHALL NOT BE DUPLICATED, USED OR DISCLOSED TO OTHERS WITHOUT THE EXPRESS WRITTEN CONSENT OF GETZ EQ.

REV	DRAWING CHANGE	BY	ECN NO.	DATE	MATERIAL	FINISH	GETZ EQUIPMENT INNOVATORS PEKIN, IL 61554		SHEET NO.	4 OF 5	BIN NO.
	TOLERANCES UNLESS OTHERWISE SPECIFIED				DWN BY CPG	CK'D K.L.R.			DWG. NO.	3G59602-4	REV.
FRAC. ±.020	2 PL DEC ±.010	3 PL DEC ±.003			SCALE 1"=1"	DATE 12-19-09	TITLE SS CONSOLE LID INTERIOR				*

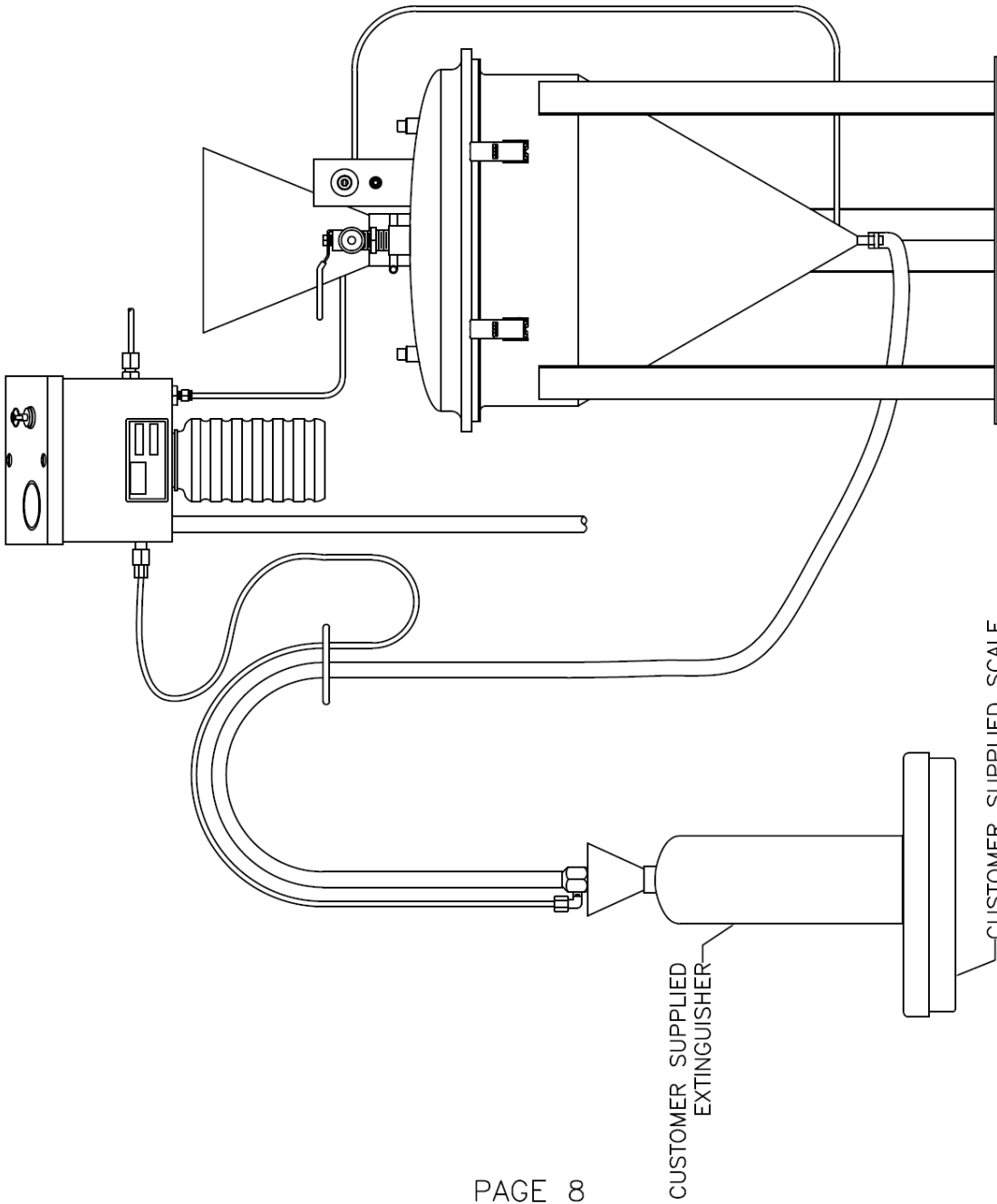

PAGE 8

CUSTOMER SUPPLIED EXTINGUISHER

CUSTOMER SUPPLIED SCALE

THIS DRAWING IS THE EXCLUSIVE AND CONFIDENTIAL PROPERTY OF GETZ EQUIPMENT. IT SHALL NOT BE DUPLICATED, USED OR DISCLOSED TO OTHERS WITHOUT THE EXPRESS WRITTEN CONSENT OF GETZ EQ.

REV	DRAWING CHANGE	BY	ECN NO.	DATE	MATERIAL	FINISH	GETZ EQUIPMENT INNOVATORS PEKIN, IL 61554	SHEET NO. 5 OF 5	BIN NO.
	TOLERANCES UNLESS OTHERWISE SPECIFIED				DWN BY CPC	CK'D K.L.R.		DWG. NO. 3G59602-5	REV. *
FRAC. ±.020	2 PL DEC ±.010	3 PL DEC ±.003			SCALE 1/8" = 1"	DATE 4-9-09	TITLE 50LB STAINLESS STEEL VF SYS		

ASSEMBLY INSTRUCTIONS

1. ASSEMBLY UNIT PER DRAWING ON PAGE 8.
 - A) INSTALL SV1 CONSOLE (#8) TO A WALL.
 - B) INSTALL RING BRACKET (#54) TO A WALL.
 - C) PLACE THE LID (#1) ON THE HOPPER (#2) WITH THE GASKET (#59) IN PLACE. LOCK THE LID DOWN WITH THE LATCHES (#52).
 - D) CONNECT THE HOSE (#5) TO THE PORT (#61) ON THE BOTTOM OF THE SV1 CONSOLE (#8).
 - E) CONNECT THE HOSE (#31) TO THE 1/4" HOSE PORT ON THE BOTTOM OF THE HOPPER (#2).
 - F) CONNECT THE HOSE (#60) TO THE PORT (#35) ON THE LEFT SIDE OF THE SV1 CONSOLE (#8).
 - G) ASSEMBLE 1/2" CLEAR HOSE (#6) TO THE OUTLET ON BOTTOM OF HOPPER.

NOTE: YOU WILL FIND IT MUCH EASIER TO GET THE HOSE ON THE BOTTOM OF HOPPER IF YOU PREHEAT THE END OF HOSE IN A CUP OF VERY HOT WATER.
 - H) ATTACH THE 6' PIECE OF 1/2" TUBING (#65) TO THE VENT HOSE CONNECTION WHICH IS THE WHITE PLASTIC NIPPLE ON THE BOTTOM OF THE CONSOLE. THIS IS AN AIR VENT LINE.
 - I) ATTACH CONNECTOR (#17) FROM RIGHT SIDE OF THE CONSOLE TO YOUR REGULATED AIR SUPPLY. (APPROXIMATELY 65 PSI)
2. APPLY PRESSURE TO THE CONSOLE AND ADJUST YOUR REGULATOR FOR APPROXIMATELY 50 TO 80 PSI. (SEE PAGE 1 FOR PROPER REGULATOR SETTING.)

PORTABLE EXTINGUISHER DISCHARGE INSTRUCTIONS

1. MAKE SURE THE PORTABLE EXTINGUISHER IS PRESSURIZED.
2. IF PORTABLE EXTINGUISHER IS NOT PRESSURIZED, AND IS FULL OR PARTIALLY FULL OF CHEMICAL, DISCHARGE THE CONTENTS OF THE EXTINGUISHER INTO THE HOPPER SYSTEM AND POUR OUT OR VACUUM THE REMAINING CHEMICAL FROM THE EXTINGUISHER.
3. CONNECT PROPER DISCHARGE ADAPTER WITH MALE QUICK COUPLER (#50) INTO VALVE ASSEMBLY OF EXTINGUISHER.
4. CONNECT DISCHARGE ASSEMBLY HOSE (#3) TO THE DISCHARGE ADAPTER (#50) ON EXTINGUISHER.
5. MAKE SURE THE POWDER RECOVERY LID (#1) IS PROPERLY CLAMPED TO HOPPER (#2).
6. CLOSE VALVE (#45) AND PARTIALLY DISCHARGE EXTINGUISHER INTO THE DISCHARGE HOSE (#47) TO INSPECT CHEMICAL.
7. IF CHEMICAL APPEARS TO BE OK, YOU MAY OPEN VALVE (#45) WHICH WILL LET THE CHEMICAL ENTER THE HOPPER AND ALLOW NITROGEN PRESSURE TO ESCAPE THROUGH THE POWDER RECOVERY FILTER (#25).
8. AFTER THE EXTINGUISHER'S PRESSURE GAUGE HAS REACHED ZERO, CLOSE THE VALVE (#45). YOU MAY DISCONNECT THE DISCHARGE ASSEMBLY HOSE (#3) AND PROCEED TO INSPECT OR HYDROTEST THE EXTINGUISHER.
9. PERFORM EXTINGUISHER MAINTENANCE PER MANUFACTURER'S REQUIREMENTS:
 - A. CLEAN ALL POWDER OUT OF THREADS OF NECK OF EXTINGUISHER. (USE A TOOTHBRUSH).
 - B. CLEAN INTERIOR OF VALVE ASSEMBLY AND VALVE STEM. (THIS IS VERY IMPORTANT TO MAKE SURE EXTINGUISHER DOES NOT LEAK OFF).
 - C. CLEAN THREADS ON VALVE ASSEMBLY AND CLEAN AND LUBRICATE O-RING.
 - D. REFILL THE EXTINGUISHER WITH CHEMICAL. (SEE PAGE 11)

FILLING EMPTY DRY CHEMICAL EXTINGUISHERS

1. MAKE SURE SCALE IS PERFECTLY SET AND BALANCED TO ZERO.
2. MAKE SURE EMPTY DRY CHEMICAL EXTINGUISHER IS VISUALLY CHECKED ON THE INSIDE FOR DRYNESS AND CORROSION WITH INSPECTION LIGHT.
3. CHECK LABEL ON EMPTY EXTINGUISHER FOR TYPE OF CHEMICAL TO BE FILLED WITH.
4. SET EMPTY EXTINGUISHER ON SCALE AND CHECK PROPER WEIGHT TO BE FILLED ON EXTINGUISHER LABEL.
5. ONCE PROPER CHEMICAL IS DETERMINED, TAKE FILLING LINE (#6) AND EXTEND IT TO THE TOP OF THE EMPTY CYLINDER TO BE FILLED.
6. TAKE THE RUBBER CONE (#7) ON THE END OF THE FILLING LINE (#6) AND PLACE INTO TOP OF CYLINDER NECK WITH A 1/4 TURN CLOCKWISE.
7. SCALE: TWO WAYS OF WEIGHING EXTINGUISHER FOR PROPER FILLING:
 - A. WITH EXTINGUISHER AND FILLING LINE ATTACHED ON SCALE, RETURN SCALE BACK TO ZERO AND PROCEED TO FILL TO RECOMMENDED WEIGHT.
 - B. WITH EXTINGUISHER AND FILLING LINE ATTACHED ON SCALE, YOU CAN ADD RECOMMENDED WEIGHT TO THE WEIGHT READING OF EXTINGUISHER AND FILL LINE PRESENTLY ON SCALE.
8. TURN ON-OFF VALVE (#19) TO THE "ON" POSITION UNTIL EXTINGUISHER REACHES RECOMMENDED WEIGHT. THEN TURN VALVE TO "OFF" POSITION ONCE EXTINGUISHER IS FILLED. (IF CHEMICAL RETURNS TO PLASTIC JAR BEFORE REACHING PROPER WEIGHT, LET CHEMICAL SETTLE THEN TURN VALVE BACK TO "ON" TO GET RECOMMENDED WEIGHT).
9. REMOVE FILLING LINE CONE (#7) FROM NECK OF EXTINGUISHER TO FILLING LINE RING BRACKET (#54).

TROUBLE SHOOTING AND SERVICE AIDS

1. CHEMICAL WILL NOT FLOW WHEN:
 - A. EXTINGUISHER IS NOT VACUUM TIGHT. (i.e., A CARTRIDGE EXTINGUISHER WITH A LEAKY CARTRIDGE RECEIVER.)
 - B. THERE IS A KINK IN A HOSE.
 - C. THE FILLING LINE AND/OR VACUUM LINE ARE CLOGGED.

NOTE: NEVER BLOW AIR PRESSURE INTO THE VACU-FILL CONSOLE OR JAR ASSEMBLY. MAY CAUSE DAMAGE TO THE CONSOLE AND INJURY.
 - D. JAR FILTER ASSEMBLY ON CONSOLE IS NOT PROPERLY SEALED. (JAR MUST BE SCREWED ON TIGHT.)
 - E. AIR SUPPLY IS NOT REGULATED AND MAINTAINED AT 50 TO 80 PSI.
2. FILTER JARS LOCATED UNDER CONSOLE SHOULD NEVER BE ALLOWED TO FILL MORE THAN HALF WAY BEFORE EMPTYING.
 - A. FILTER ELEMENT IN JARS MAY BE BLOWN CLEAN WITH AN AIR GUN OR SIMILAR DEVICE WEEKLY. REPLACE FILTER TWICE A YEAR.
3. THE ON/OFF VALVE (#19) ON THE CONSOLE MAY, AFTER A PERIOD OF TIME, TEND TO TIGHTEN UP OR BECOME HARDER TO OPERATE.
 - A. FIRST THING SHUT OFF AIR PRESSURE TO CONSOLE AND BLEED OUT ALL PRESSURE IN THE SYSTEM.
 - B. TO DISMANTLE VALVE (#19), SIMPLY LOOSEN THE NUT OR CAP AROUND THE STEM, (COUNTER-CLOCKWISE) AND USING THE HANDLE, TURN TO "ON" POSITION AND PULL ENTIRE STEM, NUT AND BUSHING OUT OF THE VALVE BODY. NOTE THE POSITION OF THE KEY JUST BEHIND THE SPRING SO YOU CAN REASSEMBLE VALVE CORRECTLY.

(SEE PAGE 5)

USING CARBURETOR CLEANER OR SIMILAR CLEANER, CLEAN INNER VALVE BODY AND THE BUSHING WITH THREE HOLES IN IT.

PUT A THIN FILM OF LUBRIPLATE, OR SIMILAR LUBRICANT, ON BOTH PARTS.

PULL THE SMALL INNER "O" RING AND THE SPRING TOWARDS THE HANDLE AND REASSEMBLE VALVE, MATING KEY WASHER IN THE VALVE SLOT. (THE SMALL O-RING SEALS AND PREVENTS LEAKS AROUND STEM.)

TROUBLE SHOOTING AND SERVICE AIDS

(CONTINUED)

TO DETERMINE IF THE PROBLEM IS IN THE CONSOLE, REMOVE VACUUM LINE (#60) FROM CONNECTOR (#35) LOCATED ON LOWER LEFT SIDE OF CONSOLE.

NOW, WITH THE VACUUM LINE (#60) REMOVED FROM THE OUTSIDE OF CONSOLE, PLACE YOUR FINGER OVER THE FITTING, (#35), ON THE OUTSIDE OF THE CONSOLE AND TURN ON THE VALVE. YOU SHOULD FEEL SUCTION HERE, AND THE GAUGE SHOULD READ OVER 15" OF VACUUM. IF NOT, MAKE SURE JAR GASKET IN (#37) IS IN PLACE AND MAKE SURE THE JAR IS TIGHT AGAINST GASKET.

DO NOT BLOW AIR THROUGH CONSOLE OR JAR ASSEMBLY

JAR IS LIKELY TO EXPLODE IF SUBJECT TO MORE THAN 5 PSI

IF YOU HAVE SUCTION AT FITTING (#35), YOU CAN BE ASSURED THAT THE TROUBLE IS NOT IN THE CONSOLE.

MOST COMMON PROBLEMS OUTSIDE THE CONSOLE ARE: LUMPY CHEMICAL, MOIST CHEMICAL, AND A PLUGGED FILLING HOSE.

CHEMICAL COMPACTION

SHOULD THE CHEMICAL IN THE HOPPER BECOME SETTLED AND COMPACTED, IT WILL BE MORE DIFFICULT TO REFILL AN EXTINGUISHER. PUSH DOWN ON TOGGLE SWITCH (#55) TO CORRECT THIS PROBLEM. HOLD IT FOR NO MORE THAN 10 SECONDS TO FLUFF THE CHEMICAL.

CAUTION: HOLDING THE SWITCH DOWN FOR TOO LONG MAY CAUSE DAMAGE TO YOUR FILTER.

RECOMMENDED MAINTENANCE KIT

DEAR CUSTOMER:

YOUR RECENT PURCHASE OF OUR VACU-FILL SYSTEM WILL PROVIDE YOU WITH MANY YEARS OF DEPENDABLE SERVICE.

REST ASSURED YOU HAVE PURCHASED THE FINEST SYSTEM AVAILABLE IN TODAY'S MARKETPLACE. THE ADVANCED ENGINEERING AND TECHNOLOGICAL ADVANCEMENT EMPLOYED IN THE DEVELOPMENT OF THIS QUALITY PRODUCT HAS MADE IT WITHOUT EQUAL, WORLDWIDE.

WHILE THIS SYSTEM IS PERHAPS THE MOST MAINTENANCE-FREE OF ANY WE MANUFACTURE, IT MUST BE REMEMBERED THAT ANYTHING MAN-MADE IS CAPABLE OF MALFUNCTIONING AND MAY REQUIRE SIMPLE REPAIR.

FOR THIS REASON, WE HAVE PUT TOGETHER A MAINTENANCE KIT WHICH WILL ELIMINATE THE NEED FOR DELAY SHOULD YOUR SYSTEM EVER FAIL. CHANCES ARE IT WON'T. YET, ON OCCASION PROBLEMS DO ARISE FOR ONE REASON OR ANOTHER. CALL IT AN EXTRA OUNCE OF SECURITY.

I URGE YOUR CONSIDERATION AND MODEST INVESTMENT IN THE FOLLOWING. SHOULD YOU EVER EXPERIENCE A PROBLEM, CHANCES ARE YOU'LL BE EQUIPPED TO REPAIR IT ON THE SPOT.

1 - 3G59639 - KIT SERV & MAINT SV1 SS CONVENT

SINCERELY,

Getz Equipment Innovators

*NOTE:
DO NOT MODIFY ANY COMPONENTS WITHIN THIS SYSTEM. ANY USE OF PARTS OTHER THAN GETZ EQUIPMENT INNOVATORS COMPONENTS EXCLUDES ALL WRITTEN AND IMPLIED LIABILITIES.*